



BALANCING FINANCIAL AND NON-FINANCIAL WEALTH

18th EIASM WORKSHOP ON FAMILY FIRM MANAGEMENT RESEARCH

Naples 2023

BALANCING FINANCIAL AND NON-FINANCIAL WEALTH

NAPLES, ITALY, OCTOBER 2-3, 2023

Full Program

Conference Venue – Centro Congressi “Federico II”

02/10/2023 - Day 1

| | |
|-------|---|
| 08.30 | Registration |
| 09.30 | Welcome |
| 10.00 | Keynote Speech – Michiels Anneleen |
| 11.00 | Coffee Break |
| 11.30 | <u>Parallel Sessions (1)</u> |
| 13.30 | Light Lunch |
| 14.30 | Keynote Speech – Nordqvist Mattias |
| 15.30 | Coffee Break |
| 16.00 | <u>Parallel Sessions (2)</u> |
| 18.00 | End |
| 20.00 | <u>Gala Dinner</u> |

03/10/2023 - Day 2

| | |
|-------|---------------------------------------|
| 09.00 | <u>Parallel Sessions (3)</u> |
| 11.00 | Coffee Break |
| 11.30 | <u>Parallel Sessions (4)</u> |
| 13.30 | Light Lunch |
| 14.30 | Keynote Speech – Astrachan Joe |
| 15.30 | Coffee Break |
| 16.00 | <u>Parallel Sessions (5)</u> |
| 17.30 | Concluding Remarks |
| 18.00 | End |
| 20.00 | <u>Social Dinner</u> |

PARALLEL SESSIONS 1 - MONDAY 11.30-13.30

| Disclosure and CSR - Chair Meurer Madeleine: Room 'Aula A' (ground floor) | | | |
|---|------------------|--------------------------------------|--|
| Paper | Presenter | University | Co-authors |
| THE INFLUENCE OF FAMILY HETEROGENEITY ON CORPORATE SOCIAL RESPONSIBILITY: A SOCIO-EMOTIONAL WEALTH APPROACH | SHANKER, MEERA | S.N.D.T WOMEN'S UNIVERSITY | |
| DISCLOSURE PRACTICES AND MODERATING IMPACTS IN FAMILY AND NON-FAMILY FIRMS | APPLETON, SAMUEL | UNIVERSITY OF BERGAMO | SAMUEL ASHONG, MARA BRUMANA, GIOVANNA CAMPOPIANO |
| MULTIPLE CASE STUDY ANALYSIS ON THE CONSEQUENCES OF MANDATORY SUSTAINABILITY REPORTING IN PRIVATE GERMAN FAMILY FIRMS | EBNER, RALF | TECHNISCHE UNIVERSITÄT MÜNCHEN (TUM) | ALEXANDRA KNOTH |
| ENVIRONMENTAL DISCLOSURE AND BOARD GENDER DIVERSITY IN FAMILY AND NON-FAMILY FIRMS | VENA, LUIGI | CATTANEO UNIVERSITY - LIUC | BARBARA MAGGI, RAFAELA GJERGJI, SALVATORE SCIASCIA, ALESSANDRO CORTESI |

| Succession and governance - Chair Calabrò Andrea: Room 'Aula B' (ground floor) | | | |
|--|----------------------|---|--|
| Paper | Presenter | University | Co-authors |
| CONFIGURATIONS FOR POST-SUCCESSION CHANGE: WHEN ARE NEW CEOS ABLE TO FACILITATE CHANGE? | WALDKIRCH, MATTHIAS | JÖNKÖPING UNIVERSITY, JÖNKÖPING INTERNATIONAL BUSINESS SCHOOL | REIMAR BELSCHNER, NADINE KAMMERLANDER |
| RETHINKING THE MERITS OF FAMILY FIRM EXPOSURE OF THE CEO PRIOR TO FAMILY BUSINESS SUCCESSION | AHRENS, JAN-PHILIPP | UNIVERSITY OF MANNHEIM | BARIS ISTIPLILER, ANDREW ISAAK, SULEIKA BORT |
| FAMILY FIRMS' BOARDS AND THEIR SUPPORT TO THE SUCCESSOR: THE ROLE OF EMOTIONAL INTELLIGENCE SKILLS OF FEMALE DIRECTORS | KALLMUENZER, ANDREAS | LA ROCHELLE BUSINESS SCHOOL - EXCELIA GROUP | SOUMAYA SFEIR |
| ESCALATING INDECISION IN FAMILY FIRMS: EVIDENCE A FROM A MULTI-FAMILY SUCCESSION PROCESS | MEGLIO, OLIMPIA | FEDERICO II UNIVERSITY OF NAPLES | GIOVANNA CAMPOPIANO |

| Ownership and governance - Chair Carbone Emmadonata: Room 'Aula C' (ground floor) | | | |
|--|--------------------------|--|--|
| Paper | Presenter | University | Co-authors |
| GOVERNING OWNERSHIP ACROSS GENERATIONS – HOW FAMILY BUSINESSES GOVERN THEIR OWNERSHIP TO ACHIEVE THEIR GOALS FOR BUSINESS AND FAMILY | IKÄHEIMONEN, TUULI | LUT UNIVERSITY (LAPPEENRANTA-LAHTI UNIVERSITY OF TECHNOLOGY LUT) | SANJAY GOEL, MARITA RAUTIAINEN |
| BUNDLES OF SLACK AND SMES' STRATEGIC CHANGES: THE ROLE OF FAMILY OWNERSHIP | LAVEREN, EDDY | UNIVERSITY OF ANTWERP | TRISTAN DE BLICK, INE PAELEMAN |
| INVESTIGATING THE IMPACT OF TEMPORAL PERCEPTIONS AND FAMILY OWNERSHIP ON ORGANIZATIONAL AMBIDEXTERITY IN SMES | SCHULZ, ANN-CHRISTINE | FHWIEN UNIVERSITY OF APPLIED SCIENCES OF WKW | ARTHUR POSCH, CHRISTIAN GARAU, PATRICK RUPPRECHT |
| THE IMPACT OF FAMILY MEMBERSHIP DIVERSITY AND FAMILY GOVERNANCE PRACTICES ON ECO-INNOVATION DECISIONS | DUONG, PHUONG-ANH NGUYEN | HASSELT UNIVERSITY | WIM VOORDECKERS, JOLIEN HUYBRECHTS, FRANK LAMBRECHTS, ANITA VAN GILS |

| Entrepreneurship - Chair Hughes Mathew: Room 'Aula A1' (first floor) | | | |
|--|---------------------|---|---|
| Paper | Presenter | University | Co-authors |
| VENTURING ACTIVITIES BY FAMILY BUSINESS ENTREPRENEURS. THE ROLE OF PERSONAL MOTIVATIONS IN PORTFOLIO ENTREPRENEURSHIP BEHAVIORS. | BEARZI, MICHELA | UNIVERSITY OF UDINE | DANIEL PITTINO, FRANCESCA VISINTIN |
| CREATION OF FAMILY VERSUS NONFAMILY VENTURE: THE ROLE OF EXTERNAL ENABLEMENT CHARACTERISTICS | KIM, JIYOUNG | JÖNKÖPING UNIVERSITY, JÖNKÖPING INTERNATIONAL BUSINESS SCHOOL | JIYOUNG KIMJEON, DANIEL PITTINO, FRANCESCO CHIRICO, PER DAVIDSSON |
| FAMILY INVOLVEMENT IN ENTREPRENEURIAL TEAMS AND ITS EFFECT ON THE NEW VENTURE CREATION PROCESS: THE ROLE OF EXTERNAL ENABLERS | ILYAS, IMRAN | JÖNKÖPING UNIVERSITY, JÖNKÖPING INTERNATIONAL BUSINESS SCHOOL | MASSIMO BAU' |
| GLOBAL ENTREPRENEURIAL EXPANSION OF CRAFT-BASED FAMILY FIRMS | DEBELLIS, FRANCESCO | VIENNA UNIVERSITY | EMANUELA RONDI, ALFREDO DE MASSIS, VITTORIA MAGRELLI |

PARALLEL SESSIONS 2 - MONDAY 16.00-18.00

Emotions - Chair Cestino Castilla Joaquin: Room 'Aula A' (ground floor)

| Paper | Presenter | University | Co-authors |
|---|----------------------------|--|--|
| EMOTIONAL DISPLAY OF FAMILY BUSINESS MEMBERS AND OUTSIDERS' REACTIONS: AN EXPERIMENTAL STUDY ON VICARIOUS GUILT AND SHAME | BERNHARD, FABIAN | EDHEC BUSINESS SCHOOL | VERA HAMPEL |
| EMOTIONS, AMBIVALENCE AND THE FAMILY DECISION TO INNOVATE: EXPLORING THE EMOTIONAL NEXUS BETWEEN FAMILY AND FIRM | D'ALLURA, GIORGIA M. | UNIVERSITY OF CATANIA | MARIASOLE BANNÒ, EMILIA FILIPPI |
| THE INFLUENCE OF FAMILY RELATIONSHIPS AND EMOTIONS ON THE DECISION OF REENTRY VERSUS SELLING- (UN)BALANCING NON-FINANCIAL VERSUS FINANCIAL WEALTH | SANDINO VARGAS, ENRIQUE | JÖNKÖPING UNIVERSITY, JÖNKÖPING INTERNATIONAL BUSINESS SCHOOL | MARCELA RAMIREZ- PASILLAS, LEONA ACHTENHAGEN |
| INVESTIGATING THE FAMILY RE-ENTRY INTO THE COMPANY. A PSYCHOLOGICAL OWNERSHIP APPROACH | RUNFOLA, ANDREA | UNIVERSITY OF PERUGIA | ALESSANDRO CIRILLO, SIMONE TERZANI |

Digitalization and innovation - Chair De Massis Alfredo: Room 'Aula B' (ground floor)

| Paper | Presenter | University | Co-authors |
|--|------------------|--|--|
| EXPLORING THE IMPACT OF FAMILY BUSINESSES' LONG-TERM ORIENTATION ON THEIR DIGITAL TRANSFORMATION PROCESS | ESLAMI, MOHAMMAD | JÖNKÖPING UNIVERSITY, JÖNKÖPING INTERNATIONAL BUSINESS SCHOOL | LEONA ACHTENHAGEN, KAJSA HAAG, DAVID HETZ, JOAKIM TRAUNTSCHNIG |
| DIGITAL INNOVATION IN FAMILY FIRMS: STATE-OF-THE-ART AND FUTURE RESEARCH AGENDA | POSA, MICHELE | LUM JEAN MONNET UNIVERSITY | ANTONELLO GARZONI, GIUSTINA SECUNDO |
| ARTIFICIAL INTELLIGENCE AND FAMILY BUSINESS: ON THE BRINK OF A REVOLUTION? | HENSSEN, BART | ODISEE UNIVERSITY COLLEGE | DRIES COUCKUYT |
| FIRM INNOVATIVENESS AND SOCIOEMOTIONAL WEALTH (SEW) IN FAMILY FIRMS: EXPLORING THE IMPACT AND MODERATING ROLES | HU, QILIN | LOUGHBOROUGH UNIVERSITY | SIQI DAI, MATHEW HUGHES |

Individual, board and family dynamics - Chair Pieper Torsten: Room 'Aula C' (ground floor)

| Paper | Presenter | University | Co-authors |
|--|---------------------|--|--|
| EXIT AS A CRITICAL COMPONENT OF THE FAMILY BUSINESS CONTINUITY PROCESS ACROSS GENERATIONS: REVIEW AND RESEARCH AGENDA | AKHTER, NAVEED | JÖNKÖPING UNIVERSITY, JÖNKÖPING INTERNATIONAL BUSINESS SCHOOL | BRYAN MALKI, REMEDIOS HERNÁNDEZ-LINARES |
| FAMILY HETEROGENEITY IN BOARD COMPENSATION: THE INCENTIVE ROLE FOR NON-FAMILY DIRECTORS | MANZI, MARIA ANGELA | FEDERICO II UNIVERSITY OF NAPLES | ALESSANDRO CIRILLO, ANNELEEN MICHIELS |
| SHEDDING LIGHT ON THE FOUNDER'S INFLUENCE: DEVELOPMENT OF A SCALE TO MEASURE EMPLOYEES PERCEPTIONS OF THE FOUNDER'S SHADOW | DINIS, LILIANA | NOVA BUSINESS SCHOOL OF ECONOMICS | PEDRO NEVES, ARMÉNIO REGO |
| AGENT-AGENT CONFLICT: BOARD INDEPENDENCE, CO-CEOS AND FIRM EXPORTING IN FAMILY FIRMS | CAMBREA, DOMENICO | UNIVERSITY OF MODENA AND REGGIO EMILIA | ZONA FABIO, QUARATO FABIO, COLLER GRAZIANO |

Technology - Chair Brumana Mara: Room 'Aula A1' (first floor)

| Paper | Presenter | University | Co-authors |
|--|--------------------------------------|--|--|
| INNOVATION THROUGH DIGITAL TECHNOLOGIES: IS THERE A FAMILY FIRM EFFECT? | KUNECOVA, JANA | UNIVERSITY OF GIRONA | ANDREA BIKFALVI, PILAR MARQUES |
| THE INFLUENCE OF FAMILY MANAGEMENT ON TECHNOLOGY ADOPTION | LENIHAN, NIAMH | MUNSTER TECHNOLOGICAL UNIVERSITY | JANE BOURKE |
| DIGITAL TECHNOLOGIES IN THE MECHANICAL ENGINEERING INDUSTRY: TOWARD A DIGITAL TECHNOLOGY PERSPECTIVE IN FAMILY BUSINESS RESEARCH | MEURER, MADELEINE | JÖNKÖPING UNIVERSITY, JÖNKÖPING INTERNATIONAL BUSINESS SCHOOL | MATTHIAS WALDKIRCH |
| DIGITAL TRANSFORMATION OF FAMILY BUSINESS: A SYSTEMATIC LITERATURE REVIEW | LÓPEZ-FERNÁNDEZ, MARIA CONCEPCION | UNIVERSITY OF CANTABRIA | REMEDIOS HERNÁNDEZ- LINARES, VANESSA DÍAZ-MORIANA, JOSÉ CARLOS CASILLAS, ANA M. MORENO- MENEZ |

PARALLEL SESSIONS 3 - TUESDAY 09.00-11.00

| Employment and career - Chair Waldkirch Matthias: Room 'Aula A' (ground floor) | | | |
|--|------------------|--|---|
| Paper | Presenter | University | Co-authors |
| HOW ENTREPRENEURIAL ORIENTATION WORKS IN FAMILY SMES? THE EFFECT OF EMPLOYEE INITIATIVE | HU, MIN | ZHEJIANG UNIVERSITY | ZILIN HE, ASTRID KRAMER |
| CEO CAREER HORIZON, STRATEGIC DISCLOSURE AND FAMILY FIRMS: EVIDENCE FROM ITALY | SAGGESE, SARA | FEDERICO II UNIVERSITY OF NAPLES | EMMADONATA CARBONE, FABRIZIA SARTO |
| "THE EMPLOYEES ARE ALL EQUAL... BUT SOME ARE MORE EQUAL THAN OTHERS". THE ROLE IDENTITY AS AN ANTIDOTE TO ADVERSE SELECTION AND OUT-GROUP DISCRIMINATION IN FAMILY FIRMS | FERRARI, FILIPPO | BOLOGNA UNIVERSITY / DEPARTMENT OF ECONOMICS | |
| EXECUTIVE TURNOVER IN FAMILY FIRMS | HUGHES, MATHEW | UNIVERSITY OF LEICESTER | FERNANDO MUÑOZ-BULLON, MARIA J. SANCHEZ-BUENO |

| NextGen & transgenerational entrepreneurship - Chair Prügl Reinhard: Room 'Aula B' (ground floor) | | | |
|--|---------------------------|---|----------------------------------|
| Paper | Presenter | University | Co-authors |
| SPARKING ENTREPRENEURSHIP THROUGH STEPPARENTAL INFLUENCE | BAUSKE, LAURA | JÖNKÖPING UNIVERSITY, JÖNKÖPING INTERNATIONAL BUSINESS SCHOOL | LUCIA NALDI, MASSIMO BAÙ |
| MANAGING PAST, PRESENT AND FUTURE THROUGH LEGACY WORK: INSIGHTS FROM FAMILY FIRMS | CESTINO CASTILLA, JOAQUIN | JÖNKÖPING UNIVERSITY, JÖNKÖPING INTERNATIONAL BUSINESS SCHOOL | OLOF BRUNNINGE, BÖRJE BOERS |
| JAPANESE LONGEVITY FAMILY BUSINESS AND TRANSGENERATIONAL ENTREPRENEURSHIP IN REGIONAL COMMUNITY | INAGAKI, KYOSUKE | HOSEI UNIVERSITY | YASUHIRO OCHIAI |
| THE ROLE OF FAMILY VALUES IN BUSINESS STRATEGY AND MANAGEMENT: A MULTIPLE GENERATION PERSPECTIVE | BADIA, FRANCESCO | UNIVERSITY OF BARI ALDO MORO | GRAZIANA GALEONE, SIMONA RANALDO |

| Sustainability - Chair Debellis Francesco: Room 'Aula C' (ground floor) | | | |
|---|-------------------------|----------------------------------|--|
| Paper | Presenter | University | Co-authors |
| ESG SCORE AND MARKET VALUE: THE ROLE OF THE FAMILY FIRM. EVIDENCE FROM THE ITALIAN LISTED MARKET. | BIFULCO, GIUSEPPE MARIA | FEDERICO II UNIVERSITY OF NAPLES | RICCARDO TISCINI |
| ARE FAMILY FIRMS WILLING TO PAY TO BE SUSTAINABLE? BALANCING SOCIO-EMOTIONAL AND ECONOMIC OBJECTIVES | BOWDEN, STEPHEN | UNIVERSITY OF WAIKATO | |
| SUSTAINABLE REINVENTION: INSTITUTIONAL COMPLEXITY IN FAMILY FIRMS IN DELEGITIMIZED INDUSTRIES | EHLERS, ANNIKA | STOCKHOLM SCHOOL OF ECONOMICS | CAMILLE KORSCHUN |
| FINANCIAL WEALTH, SOCIOEMOTIONAL WEALTH AND SUSTAINABLE DEVELOPMENT GOALS IN FAMILY FIRMS: A MIXED GAMBLE PERSPECTIVE | MISMETTI, MARCO | FREE UNIVERSITY OF BOZEN-BOLZANO | IVAN MIROSHNYCHENKO, ALFREDO DE MASSIS |

| Strategic actions and uncertainty - Chair Henssen Bart: Room 'Aula A1' (first floor) | | | |
|---|----------------------|-----------------------------|-----------------------------------|
| Paper | Presenter | University | Co-authors |
| MANAGERIAL DYNAMIC CAPABILITIES OF MICRO AND SMALL FAMILY FIRM MANAGERS IN THE RETAIL INDUSTRY: STRATEGIC ACTIONS TO MANAGE ECONOMIC DOWNTURN | LJUNGKVIST, TORBJORN | UNIVERSITY OF SKÖVDE | BÖRJE BOERS, CHRISTOFFER AXELL |
| TOGETHER WE ARE STRONGER: THE ROLE OF EXTENDED SEW FOR THE RESILIENCE OF FAMILY FIRMS | PONGELLI, CLAUDIA | EUROPEAN UNIVERSITY OF ROME | EMANUELA DELBUFOLO |
| ENTREPRENEURIAL RESILIENCE IN TROUBLING TIMES: HOW SWEDISH SMALL- AND MEDIUM-SIZED FAMILY FIRMS NAVIGATE THROUGH UNCERTAINTY | BOERS, BÖRJE | UNIVERSITY OF SKÖVDE | ANDERS BILLSTRÖM, DANILO BROZOVIC |
| INNOVATION AND GROWTH BEHAVIOR OF FAMILY FIRMS IN TIMES OF CRISIS | SCHWEIGER, NINA | UNIVERSITY OF INNSBRUCK | IULIIA ZHELDAK, KURT MATZLER |

PARALLEL SESSIONS 4 - TUESDAY 11.30-13.30

Goals and conflicts - Chair Huybrechts Jolien: Room 'Aula A' (ground floor)

| Paper | Presenter | University | Co-authors |
|---|--------------------|--|--|
| RELATIONSHIP CONFLICT AS A STIMULUS FOR STRATEGIC FLEXIBILITY: THE MODERATING ROLE OF CEO'S SOCIAL SKILLS AND THE FAMILY NATURE OF THE FIRM | MISMETTI, MARCO | FREE UNIVERSITY OF BOZEN-BOLZANO | PAOLA ROVELLI, CRISTINA BETTINELLI, MARA BERGAMASCHI |
| FAMILY BUSINESS GROUP – BALANCING FAMILY MEMBERS INDIVIDUAL AND COLLECTIVE OWNERSHIP GOALS | RAUTIAINEN, MARITA | LUT UNIVERSITY (LAPPEENRANTA-LAHTI UNIVERSITY OF TECHNOLOGY LUT) | SANJAY GOEL |
| HOW TRANSITIVE STEWARDSHIP CAN HELP TO RESOLVE THE ECONOMIC AND NONECONOMIC FAMILY GOALS PARADOX | SIMEONOVA, BOYKA | UNIVERSITY OF LEICESTER | NEHAD ALI, MATHEW HUGHES |
| FAMILY FIRM CONFLICT ESCALATION IN ONLINE COMMUNICATION: BUSINESS FAMILIES IN DISTRESS | STRAUSS, CHRISTINA | WITTEN/ HERDECKE UNIVERSITY | ARIST VON SCHLIPPE, TORSTEN PIEPER, FRANZ KELLERMANN |

Growth and performance - Chair Ahrens Jan-Philipp: Room 'Aula B' (ground floor)

| Paper | Presenter | University | Co-authors |
|---|---------------------|------------------------------------|---|
| EXAMINING THE DUAL-SIDED SIGNALS OF THE FAMILY: EVALUATING THEIR IMPACT ON THE IPO VALUE | SANSEVERINO, ANDREA | FEDERICO II UNIVERSITY OF NAPLES | ALESSANDRO CIRILLO, MARIA ANGELA MANZI |
| DOES FAMILY POWER DRIVE THE TRANSITION FROM FAMILY SMES TO LARGE FAMILY FIRMS? | BRUNELLI, SOFIA | CATTANEO UNIVERSITY - LIUC | LUIGI VENA, SALVATORE SCIASCIA, LUCIA NALDI |
| SUPPLY CHAIN MANAGEMENT IN FAMILY BUSINESS. ACHIEVING SUSTAINABLE PERFORMANCE THROUGH SOCIO- EMOTIONAL WEALTH | PONT FARRÁS, AINA | AUTONOMOUS UNIVERSITY OF BARCELONA | ALEXANDRA SIMON |
| THE PERCEPTIONS OF FINNISH FAMILY FARMERS REGARDING ECONOMIC, EMOTIONAL, GROWTH, AND FAMILY GOALS | YIGIT, FURKAN | UNIVERSITY OF HELSINKI | LEENA RANTAMÄKI-LAHTINEN, TIMO SIPILÄINEN |

Financial and non-financial goals - Chair D'Allura Giorgia: Room 'Aula C' (ground floor)

| Paper | Presenter | University | Co-authors |
|---|-------------------|---|----------------------------------|
| THE EVOLUTION OF THE BALANCE BETWEEN FINANCIAL AND NON-FINANCIAL GOALS OVER GENERATIONS: A SOCIAL IDENTITY PERSPECTIVE | MARI, ISABELLE | EDHEC BUSINESS SCHOOL | JEAN-LUC ARREGLE |
| THE TRADE-OFF BETWEEN FINANCIAL AND NONFINANCIAL WEALTH OBJECTIVES: A STORY OF A FAMILY BUSINESS'S WEALTH AND SOCIAL VALUE CREATION OVER FIVE GENERATIONS | DAWSON, ALEXANDRA | CONCORDIA UNIVERSITY | |
| MANIFESTATION OF NON-FINANCIAL GOALS IN FAMILY ENTERPRISE FOUNDATIONS | ALMLÖF, HANNA | JÖNKÖPING UNIVERSITY, JÖNKÖPING INTERNATIONAL BUSINESS SCHOOL | KAJSA HAAG, ULF LARSSON OLAISSON |
| SAILING THE PARADOXICAL SEAS: INDIVIDUAL TRAITS IN THE DUAL BALANCE OF FINANCIAL AND SOCIOEMOTIONAL GOALS IN FAMILY BUSINESSES | KRUEGER, CLEMENS | ZEPPELIN UNIVERSITY | REINHARD PRÜGL |

Leadership and sustainable development - Chair Pongelli Claudia: Room 'Aula A1' (first floor)

| Paper | Presenter | University | Co-authors |
|---|---------------------------|--|--|
| IS CAIN MORE ABLE? A BEHAVIORAL PERSPECTIVE ON THE RELATION BETWEEN CEO BIRTH ORDER AND ENTREPRENEURIAL FIRMS' CSR | RAZEN, MICHAEL | MCI THE ENTREPRENEURIAL SCHOOL® | ALFREDO DE MASSIS, KURT MATZLER, PAOLA ROVELLI, NINA SCHWEIGER, CARLOTTA BENEDETTI |
| INTRAGENERATIONAL DYNAMICS SHAPING SIBLINGS' SHARED LEADERSHIP: A STEWARDSHIP PERSPECTIVE | MOKSTER, SIMONE | JÖNKÖPING UNIVERSITY | RANIA LABAKI, IVIJA BERNATOVIĆ |
| DEVELOPMENT OF SHARED RESPONSIBLE LEADERSHIP: THE CASE OF SMALL COMMUNITY-EMBEDDED FAMILY BUSINESSES | STANGEJ, OLGA | ISM UNIVERSITY OF MANAGEMENT AND ECONOMICS | INGA MINELGAITE |
| SUSTAINABILITY LEADERSHIP DEVELOPMENT IN FAMILY FIRMS OF THE TOURISM INDUSTRY - AN EXPLORATORY COMPARATIVE CASE STUDY | CAMPOS-I-CLIMENT, VANESSA | UNIVERSITY OF VALENCIA | ANITA ZEHRER, ANA T. EJARQUE, DESIREE WIESER, JOAN R. SANCHIS, LEENA SAURWEIN |

PARALLEL SESSIONS 5 - TUESDAY 16.00-17.30

Family development and distress - Chair Laveren Eddy: Room 'Aula A' (ground floor)

| Paper | Presenter | University | Co-authors |
|---|------------------|---|--|
| THE IMPACT OF BUSINESS OWNERS' ILLNESS ON ORGANIZATIONAL DEVELOPMENT | BAKRY, LAMIAA | JÖNKÖPING UNIVERSITY, JÖNKÖPING INTERNATIONAL BUSINESS SCHOOL | |
| BUSINESS SURVIVAL DURING ECONOMIC CRISES: A COMPARISON BETWEEN FAMILY AND NON-FAMILY FIRMS | HAYRAPETYAN, ANI | AUTONOMOUS UNIVERSITY OF BARCELONA | ALEXANDRA SIMON, PILAR MARQUES, GEMMA RENART |
| RESOLUTION OF FINANCIAL DISTRESS IN FAMILY SMES: HOW DOES SOCIOEMOTIONAL WEALTH AFFECT SECOND CHANCE? | MAGRI, CARLOTTA | UNIVERSITY OF PARMA | FEDERICO BERTACCHINI |

Context and macro dynamics - Chair Mussolino Donata: Room 'Aula B' (ground floor)

| Paper | Presenter | University | Co-authors |
|--|-----------------|--|---|
| FAMILY BUSINESS IN ENTREPRENEURIAL ECOSYSTEM: A SYSTEMATIC LITERATURE REVIEW AND BIBLIOMETRIC ANALYSIS | INTENZA, MARIKA | UNIVERSITY OF FOGGIA | ANTONIO NETTI, MAURO ROMANO, ANTONIO CORVINO |
| CONTEXTUALIZING FAMILY FIRMS' PRODUCTIVITY: THE ROLE OF LOCAL INSTITUTIONS | AMATO, STEFANO | UNIVERSITY OF TRENTO | VALENTINA PIERONI, RODRIGO BASCO, NICOLA LATTANZI |
| INFLUENCE OF NON-FINANCIAL PRIORITIES ON THE ENVIRONMENTAL PERCEPTION IN THE FACE OF ECONOMIC CHANGE | ADE, ADRIAN | HSBA HAMBURG SCHOOL OF BUSINESS ADMINISTRATION | |

Innovation and sustainable innovation - Chair Akhter Naveed: Room 'Aula C' (ground floor)

| Paper | Presenter | University | Co-authors |
|---|----------------------|--------------------------------------|-------------------------------------|
| HOW FAMILY SMES GO DIGITAL: EVIDENCE FROM SIX BUSINESS CASES | RICCIARDI, ARCANGELA | UNIVERSITÀ CATTOLICA DEL SACRO CUORE | DANIELE CERRATO |
| SUSTAINABLE INNOVATION DEVELOPMENT IN FAMILY FIRMS: A SOCIOEMOTIONAL WEALTH PERSPECTIVE | WOJTYRA, MARTA | KOZMINSKI UNIVERSITY | |
| PURPOSE DRIFT IN FAMILY FIRMS: A BUSINESS MODEL INNOVATION PERSPECTIVE | BURATTI, ANDREA | UNIVERSITY OF BERGAMO | GIOVANNA CAMPOPIANO, TOMMASO MINOLA |

Ethics and behaviours - Chair Bernhard Fabian: Room 'Aula A1' (first floor)

| Paper | Presenter | University | Co-authors |
|--|--------------------------------------|---|--|
| UNVEILING THE DYNAMIC FORCES: FAMILY FIRMS AND THE INFLUENCE OF FAMILY IN SOCIAL VALUE CREATION | STEENBEEK, ROSEMARIE | WINDESHEIM UNIVERSITY OF APPLIED SCIENCES | J.P. COEN RIGTERING, NIELS S. BOSMA, JUDITH M.C. VAN HELVERT-BEUGELS |
| UNDERSTANDING FAMILY BUSINESS PHILANTHROPY: A MULTI-DISCIPLINARY REVIEW | SIDANI, NEAMAT | VUB - VRIJE UNIVERSITEIT BRUSSEL | STIJN VAN PUYVELDE |
| EARNINGS MANAGEMENT IN ITALIAN FAMILY AND NON-FAMILY UNLISTED COMPANIES: THE MODERATING EFFECT OF GENDER DIVERSITY | GIANCOTTI, MONICA CATTAFI, GIULIA | UNIVERSITY OF CATANZARO, UNIVERSITY OF MESSINA | MARIANNA MAURO |



CENTRO CONGRESSI "FEDERICO II" GROUND FLOOR

BALANCING FINANCIAL
AND NON-FINANCIAL WEALTH

18th EIASM WORKSHOP ON FAMILY FIRM MANAGEMENT RESEARCH

Naples 2023

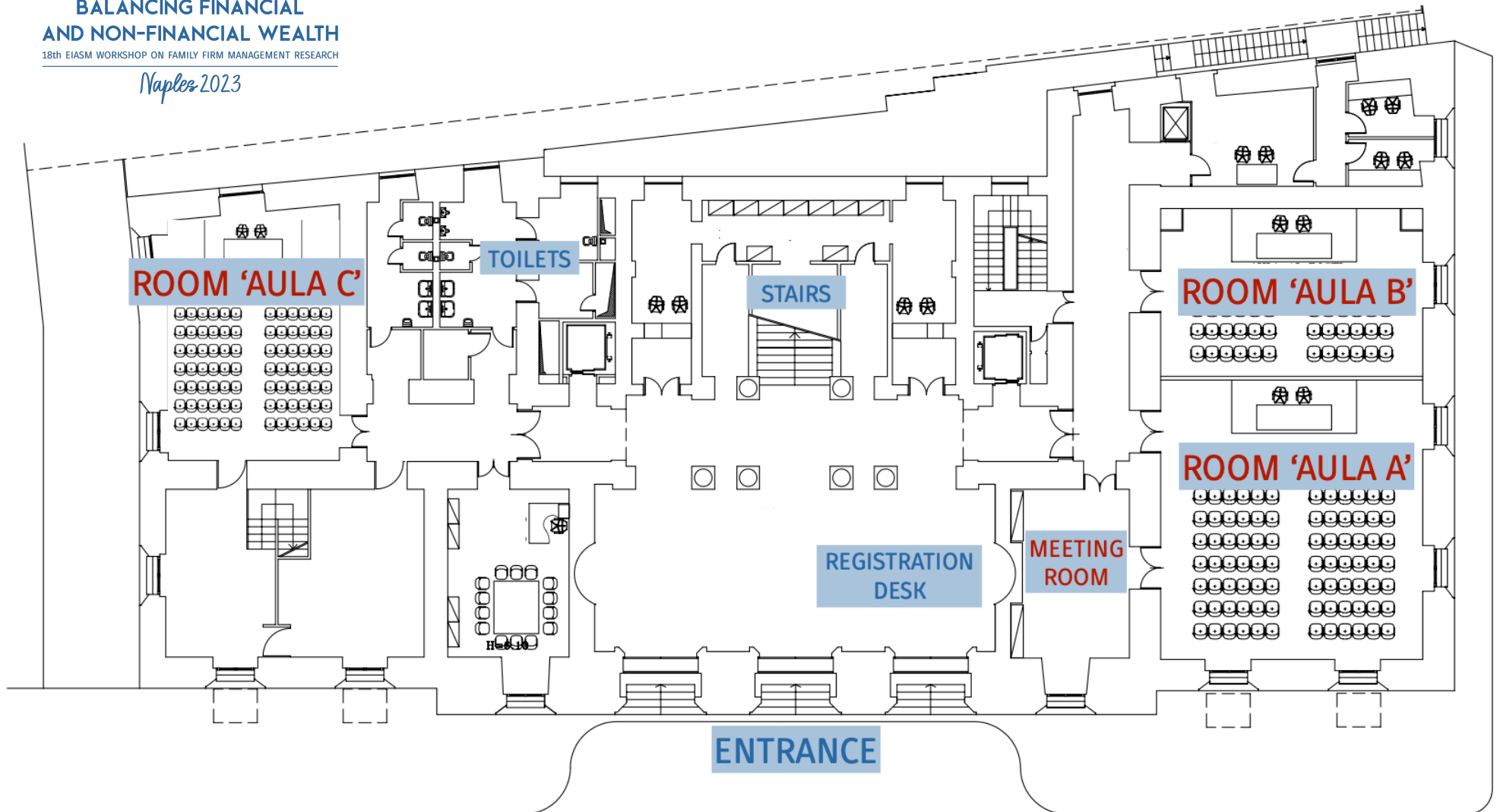



CENTRO CONGRESSI "FEDERICO II" FIRST FLOOR

BALANCING FINANCIAL
AND NON-FINANCIAL WEALTH

18th EIASM WORKSHOP ON FAMILY FIRM MANAGEMENT RESEARCH

Naples 2023

